

Fallsview Casino Resort – Grand Hall Emergency & Access Summary

1. Fire Alarm Response Procedures

Upon Discovery of Fire or Smoke:

- Leave the fire area immediately.
- Close all doors behind you.
- Activate the nearest fire alarm pull station.
- Use stairwells to leave the building—**do not use elevators**.

Fire Alarm System Overview:

Fallsview Casino Resort uses a **two-stage fire alarm system**:

- **1st Stage Alert (Slow, Single Pulse – 20 beeps/minute "church bells"):**
 - This is a warning signal; evacuation is **not** immediately required.
 - Remain calm, prepare to evacuate, and await further instruction.
 - The system will remain at this stage until acknowledged or upgraded manually/automatically after 5 minutes.
 - Patrons will hear an announcement informing them that the situation is under investigation.
- **2nd Stage Alarm (3 Pulses – "Whooping Sound"):**
 - **Immediate evacuation is required.**
 - Do **not** shout "FIRE."
 - Remove all guests and staff from the area and **close doors** behind you.
 - All magnetically locked exits will automatically release.
 - Walk—do not run—to the nearest exit.

Evacuation Assembly Areas:

After exiting the building, patrons and staff should proceed to one of the following triage locations:

- **Oakes Hotel parking lot**
- **Hilton (Fallsview Blvd.) parking lot**
- **Quality Inn Hotel Cascade Inn (Murray Hill) parking lot**

2. Fire Exit Information

All exits at Fallsview Casino Resort are compliant with the Ontario Building Code and are strategically placed throughout the complex.

Key public exit locations include:

- Around the **Casino floor**
- Two **stairwells** serving all hotel floors
- From the **Theatre/Avalon Ballroom**
- From **Retail Areas**
- Designated exits in and around the **Grand Hall**

(See Attached Diagram)

3. Emergency Medical Response

In Case of Medical Emergency:

- Notify a staff member or **contact Security at extension 59999.**

Security Response:

- Security is the first responder for all on-site medical incidents.
- Minor issues will be addressed on-site or in the **First Aid room.**
- For more serious incidents:
 - Security will call **911.**
 - Provide accurate location details and assist paramedics upon arrival.
 - Security will control crowds and provide first aid, including CPR, as needed.
 - Two **Automated External Defibrillators (AEDs)** will be brought to the scene.
 - Note: A stationary **AED unit** is located **in the Grand Hall service corridor on the Concourse level.**

4. Emergency Vehicle Access (Fire Truck / Ambulance)

While the Grand Hall is located in a quieter area of the building, it is accessible in the event of an emergency. Emergency vehicles (fire trucks, ambulances) typically:

- **Arrive via Fallsview Boulevard or Murray Street**, depending on traffic and access points.
- **Enter the building from service/loading areas or designated emergency access doors** (depending on the exact hall layout).
- Security and Engineering Dispatch will guide emergency responders to the appropriate entry closest to the Grand Hall.
- Staff should familiarize themselves with these access points and ensure they remain unobstructed at all times.

5. Directions to the Nearest Hospital

Greater Niagara General Hospital

Address: 5546 Portage Rd, Niagara Falls, ON L2E 6X2

Driving Directions from Fallsview Casino Resort (6380 Fallsview Blvd):

1. Exit the main entrance and turn **right onto Fallsview Blvd.**
2. In 200m, turn **left onto Murray Street.**
3. In 200m, turn **right onto Stanley Avenue.**
4. In 1.1 km, turn **left onto North Street.**
5. The hospital is on the **right.**

Grand Hall Emergency Exits & Group Meeting Place

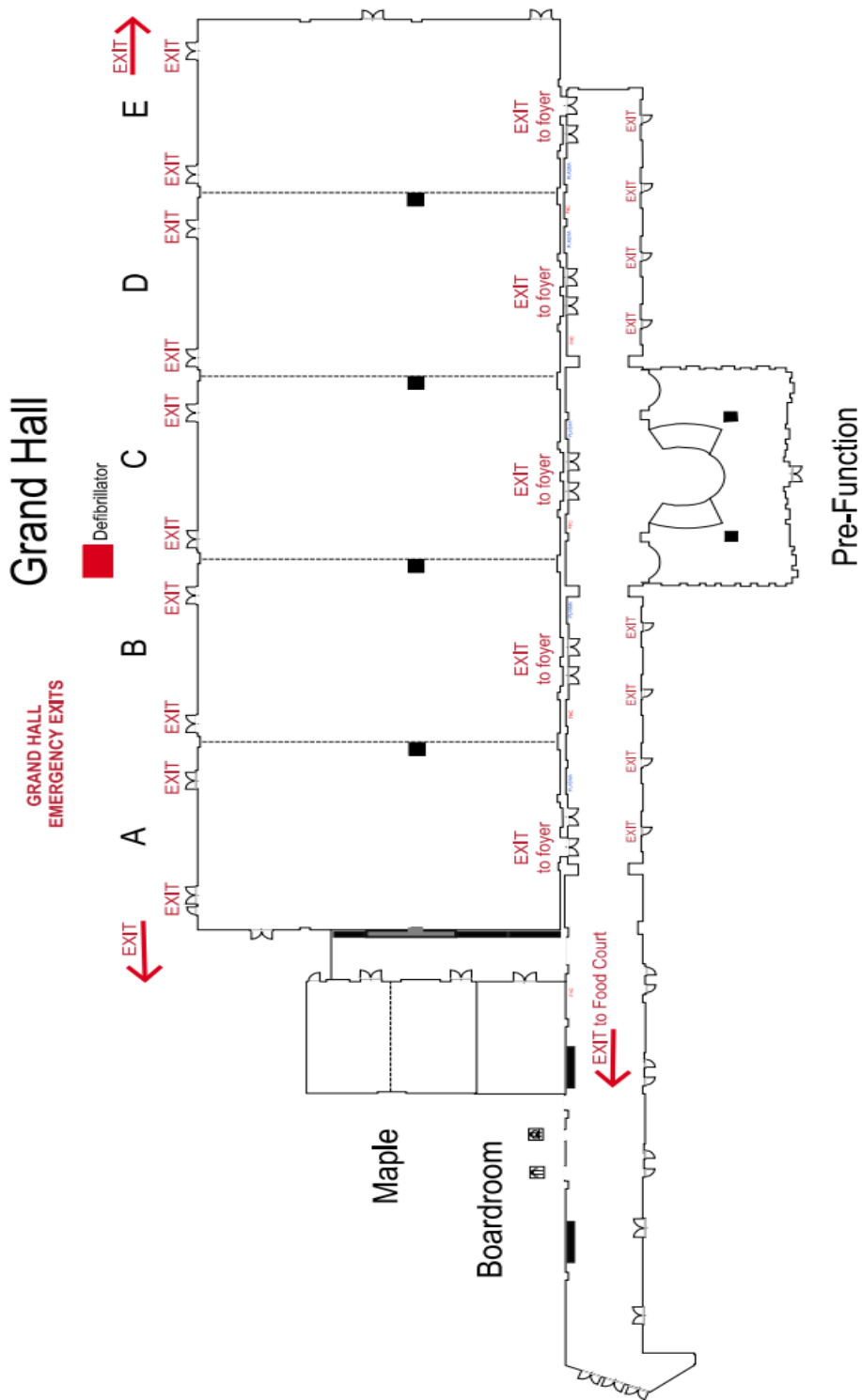

Group Meeting Place: **Quality Inn Hotel Cascade Inn (Murray Hill) parking lot**

